

EXHIBITION OPPORTUNITIES FOR ARTISTS, CURATORS & LENDERS

• 2020 OPEN CALL FOR PROPOSALS •

The Grand Galleries are a contemporary visual arts space located within the Grand Theatre Center for the Arts in historic downtown Tracy, California. This celebrated 37,000 sq.' interdisciplinary fine arts and educational facility hosts over 50,000 visitors per year, and is owned and operated by the City of Tracy. The Exhibitions Program (EP) provides professional exhibition opportunities in the Central Valley near the Bay Area and Sacramento. Negotiable funding is available for the production and display of public programming. In addition, the EP is interested in partnering on grant funded projects.

The Exhibitions Program seeks diverse programming proposals from artists, curators, educators, collectives, and collection lenders. Proposals will be reviewed by the Exhibitions Program Advisory Committee and recommended for exhibition opportunities. Proposals are open to all media including installation, new media, and performance art; there are no geographic restrictions. Work must have been completed in the past three years unless part of a thematic grouping or collection. Artists may also submit proposals for new works, providing samples of work representative for review. As the Galleries are part of a larger interdisciplinary arts center fostering community involvement and life learning, collaborators who are available for demonstration, residency, outreach, and workshop options are preferred. Proposals must be mailed as instructed below and all submitted materials should be considered a public document as property of the City of Tracy. Incomplete proposals are subject to disqualification.

For consideration please provide the following materials:

1. 10 to 15 images in the form of quality color photographs, printed reproductions, or USB Flash Drive or Mac/PC compatible CD/DVD. A corresponding image list (electronic & hard copy) that includes title, media, year of creation and size of each work. Artists working in non-traditional formats such as new media or installation may opt to submit a 3 – 10 minute video on USB Flash Drive or Mac/PC compatible CD/DVD with mpg/mov files.
2. Professional Resume or CV including Exhibition Record and Artist's Biography
3. Exhibition Concept / Statement of Intent
4. Preference for Exhibition Type such as Solo, Collaborative, Group, Thematic Group, etc.
5. Date Restrictions - Exhibitions may be scheduled up to 18 months after review.
6. Additional support materials are optional. S.A.S.E for return of materials. Failure to provide will result in the disposal of materials at the Program's discretion post-review. Select materials may be kept on file for future reference.

Mail Proposals to:

Exhibitions Program – Proposal Submission c/o Grand Theatre Center for the Arts 715 Central Avenue Tracy, CA 95376

Proposals are accepted continually and reviewed bi-annually, as needed.

For more information visit online: atthegrand.org/exhibitionsprogram



2020

ART CO-OP

Exhibition Opportunities for Artists & Makers
to participate in a curated Co-Op at the Grand Theatre Center for the Arts

The Grand Galleries are a contemporary, municipal visual arts space located within the Grand Theatre Center for the Arts in historic downtown Tracy, California. This 37,000 sq.' interdisciplinary fine arts and education facility is owned and operated by the City of Tracy. The Exhibitions Program provides professional exhibition opportunities in the Central Valley near the Bay Area and Sacramento.

Since December of 2009, the Grand Galleries have invited Artists & Lenders to be part of an exciting collaboration. The South Gallery serves as a modern curated cooperative exhibition space. Artists are needed to exhibit original artwork, limited editions and artist-designed products in the form of art making materials, arts education materials, children's creative products, clothing, jewelry, media (publications, books, cds, dvds), toys and more.

This unique venue features price points under \$500 with exclusive art and products available for a limited time. As the Galleries are part of a larger interdisciplinary arts center fostering community involvement and life learning, products incorporating arts education are encouraged. Local-area Writers, Musicians, Songwriters, Poets and Spoken-Word Artists with publications and audio/visual recordings are also invited to participate.

- Participating Artists receive 80% of sales and the Exhibitions Program retains a 20% commission.
- Local Artists are encouraged to schedule a review meeting, while out of area Artists can send:

● **Visual Artists & Lenders, for consideration please provide the following materials:**

1. 3-5 high resolution (300dpi) photographic images via email or mail a Mac/PC compatible cd/dvd/flash. Corresponding image list that includes title, media, date of creation, size of each work, and retail price.
2. Professional Resume and/or Artist Biography including Exhibition Record

● **Recording Artists & Writers, for consideration please provide the following materials:**

1. Copy of publication / Audio or Video recording in the form of a CD or DVD
Provide a corresponding worksheet including album/project title, release information and retail price.
2. Promotional Biography (including band members, label information, photographs, etc. if applicable.)

● **Please deliver, send or email materials to:**

Exhibitions Program c/o
Grand Theatre Center for the Arts
715 Central Avenue Tracy, CA 95376

For more information visit online: atthegrand.org/exhibitionsprogram

Please note, submitted materials will not be returned and are considered public records.

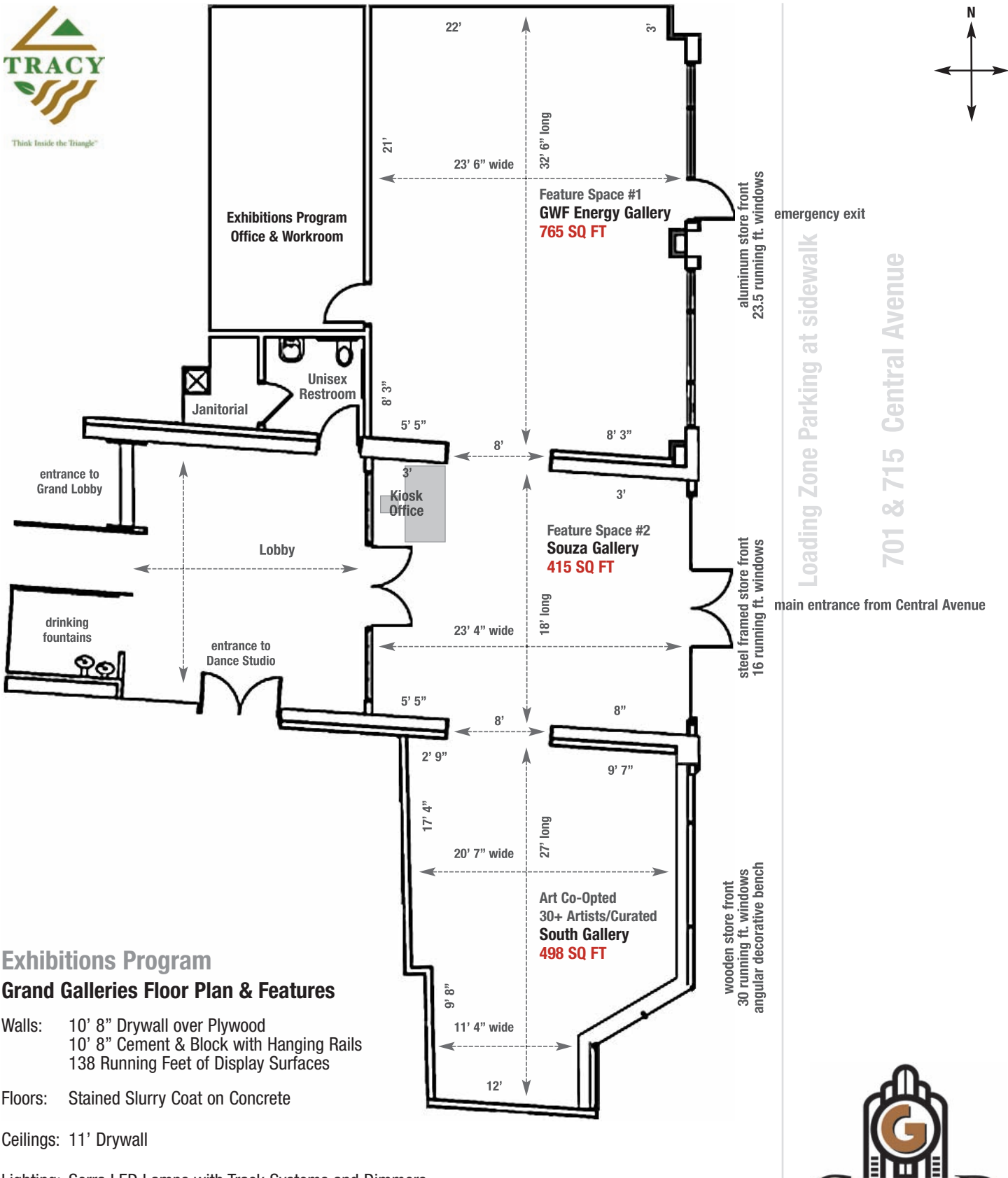

Exhibitions Program
Grand Galleries Floor Plan & Features

- Walls: 10' 8" Drywall over Plywood
 10' 8" Cement & Block with Hanging Rails
 138 Running Feet of Display Surfaces
- Floors: Stained Slurry Coat on Concrete
- Ceilings: 11' Drywall
- Lighting: Sorra LED Lamps with Track Systems and Dimmers
- Glazing: 70 Running Ft. UV Resistant Windows with Block Out Shades
- Display: Pedastals, Platforms, Shelves, Vitrines, etc.
- Security: Professional Staff & Multi-Systems Monitoring

emergency exit

Loading Zone Parking at sidewalk

701 & 715 Central Avenue

main entrance from Central Avenue

7th Street

